

STARTER KIT FOR SMARC 2.0 DEVELOPMENT

conga-SKIT/ARM i.MX8

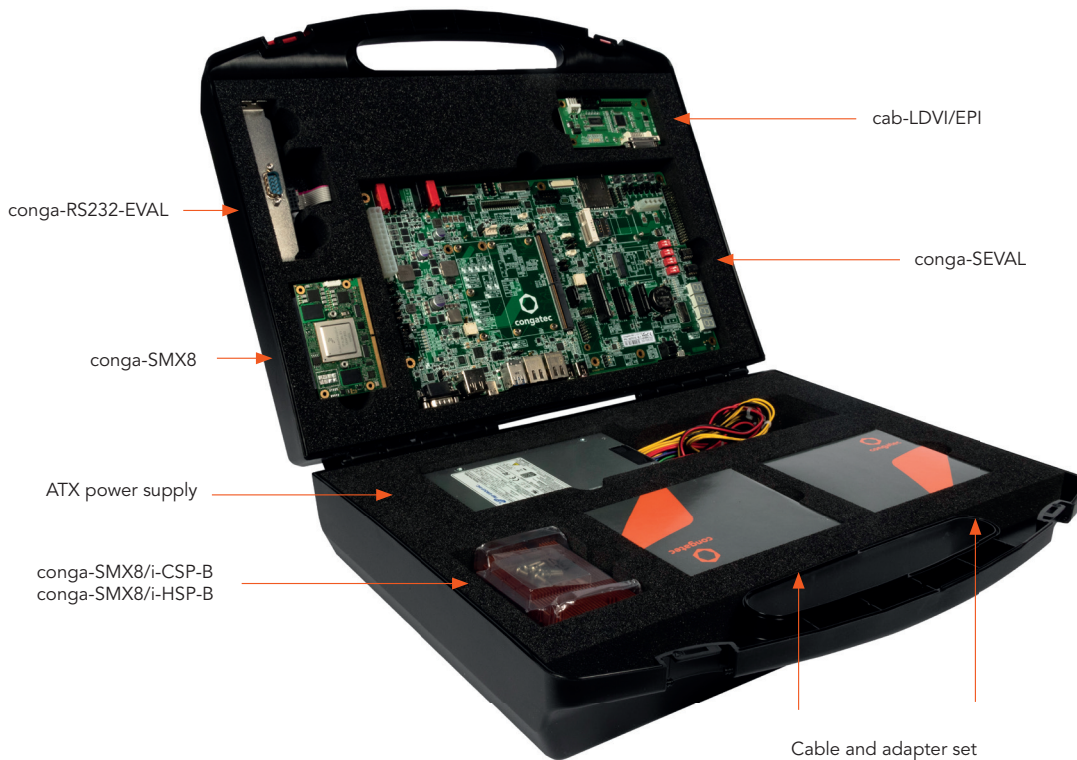

The conga-SMX8 features application processors from the NXP i.MX8 product family with up to 8 GB LPDDR4 onboard RAM and 16 GB onboard HS400 eMMC. It is available in commercial and industrial temperature range. The conga-SEVAL evaluation carrier board provides 1x PCIe x1, 1x mPCIe, 1x M.2 Key E, 1x USB 2.0 OTG Micro AB, 1x USB Type A, 1x USB 2.0 Type A, 1x USB 3.1 Type-C, 1x USB 2.0 on M.2, and 1x USB 2.0 on mPCIe. It also provides 2x RJ45 for Gigabit Ethernet, 4x COM, 2x CAN bus, 12x GPIO, Digital and analog audio I/Os for I2S and HDA. Displays can be connected via dual channel LVDS, eDP, DP and HDMI. Additional storage media are available via a SD/MMC socket and 1x SATA 6 Gbps port.

Article	PN	Description
conga-SEVAL	007010	Evaluation carrier board for standard SMARC modules based on SMARC Specification 2.0
conga-SMX8/i-QCM-6GB eMMC16	051020	SMARC 2.0 module with NXP i.MX8 QuadMax application processor, 1 MB L2 cache, 6 GB LPDDR4 onboard memory and 16 GB on-board HS400 eMMC
MicroSDHC-Card UHS-I	10000285	8GB - Kingston industrial SDCIT/EU Class 10 with preinstalled image
conga-SMX8/i-CSP-B	051050	Passive cooling solution. All stand-offs are bore hole 2.7mm
conga-SMX8/i-HSP-B	051051	Standard heatspreader. All stand-offs are bore hole 2.7mm
conga-LDVI/EPI	011115	LVDS to DVI converter board for digital flat panels with onboard EEPROM
conga-ACAM/JAL-2721	016153	MIPI camera module adapter with camera JAL-2721. Image sensor OV5640. MIPI CSI-2
Flat Foil Cable	48000026	FFC for conga-ACAM/JAL-2721. 36 pins, pitch 0.5mm, length 150mm, opposite side contact
cab-LVDV-DAT-34-15	033331	15cm data cable LVDS to DVI adapter
cab-LVDV-PWR-10-15	052147	15cm power cable LVDS to DVI adapter
USB 2.0 to Serial Adapter	10000116	USB 2.0 to Serial Adapter DSUB9 based on FTDI FT232
cab-RS232-EVAL	14000200	20cm 2x5pin female to D-Sub 9P male
SATA power cable 12cm	14000202	12cm SATA HDD 15pin SATA to 4pin ATX
RS232 adapter cable	48000023	MOLEX 6-Pin PicoBlade to two D-SUB 9
SATA III cable 30 cm	48000029	30cm SATA III cable, straight / straight
ATX Power Supply	500016	FSP180-50L max. 180 W (150 x 81.5 x 40.5 mm)
Quick Start Guide	85500014	Quick Start Guide
Safety and Regulatory Information	91500002	Safety and Regulatory Information
Wireless Content Information	91500003	Wireless Content Information

Article	PN	Description
conga-SKIT/ARM i.MX8	077660	SMARC 2.0 IoT Development Kit based on conga-SMX8 with NXP i.MX8 series processor and conga-SEVAL SMARC reference carrier